

**Repair Kits**

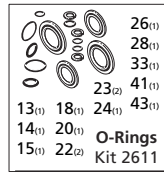
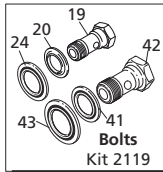
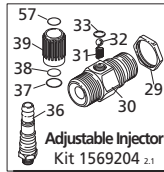
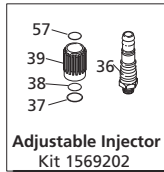

Pos	Code	Description	Qty	Pos	Code	Description	Qty	Legend
1	1560580	Handle plug	1	35	1560700	Adaptor - steel 3/8" NPT (265 in/lbs)	1	3/B
2	540290	Adjusting screw M8x25	1	36	1560110	Adaptor - brass 3/8" G (265 in/lbs)	1	For ●
3	1660210	Lock nut M8	1	37	1560111	Adaptor - steel 3/8" G (265 in/lbs)	1	AR20242
4	1560400	Unloader knob	1	38	1560650	Hose barb (adjustable)	▲ 1	3/B+ID
5	1080070	Pin	1	39	800560	O-Ring ø8.73x1.78	▲ 1	For ■
6	1560420	Adjusting cap - brass	1	40	480560	O-Ring ø6.75x1.78	▲ 1	AR20081 1.8
7	1560410	Spring guide (309 in/lbs)	1	41	1560670	Detergent regulator knob	▲ 1	AR20082 2.1
8	1560440	Spring plate	1	42	1540020	By-pass housing	1	3/B+IDR
9	1560350	Spring	1	43	1540120	Washer ø1/2"	1	
10	1080610	Spring button	1	44	1540090	Inlet bolt (354 in/lbs)	1	
11	1080660	Pin	1	45	1560710	Bolt w 1/8" tap	1	
12	1080540	Upper piston	1	46	1560290	Washer ø1/2"	1	
13	391000	O-Ring ø9.13x2.62	1	47	480440	O-Ring ø17.13x2.62	1	
14	1080640	Back-up ring	1	48	1540050	Inlet fitting 1/2" G (354 in/lbs)	1	
15	1560150	O-Ring ø5.94x3.53	1	49	1560640	Inlet fitting 1/2" G NPT (354 in/lbs)	1	
16	1560100	Shutter valve	1	50	1560660	Ring	▲ 1	
17	1560140	Spring	1	51				
18	180101	O-Ring ø17.5x2	1					
19	1540272	Mounting bolt 3/8" G (265 in/lbs)	1					
20	390080	Sealing washer ø3/8"	1					
21	1560010	Valve body	1					
22	1080550	Back-up ring	2					
23	480480	O-Ring ø4.48x1.78	2					
24	1560280	Sealing washer ø3/8"	1					
25	1560320	Lower piston	1					
26	880270	O-Ring ø17.17x1.78	1					
27	1560051	By-pass adaptor (309 in/lbs)	1					
28	390080	O-Ring ø11.91x2.62	1					
29	1560510	Lock nut	▲ 1					
30	1560500	Injector body 3/8" G 1.8 (309 in/lbs)	▲ 1					
31	1560530	Injector body 3/8" G 2.1 (309 in/lbs)	▲ 1					
32	1560520	Spring	▲ 1					
33	1250280	Ball	▲ 1					
34	480480	O-Ring ø4.48x1.78	▲ 1					
35	1560490	Hose barb (fixed) (35 in/lbs)	■ 1					

**DESIGNED FOR  
XM, RK AND RR PUMPS  
UP TO 3650 PSI**